

A Parents' Guide to getting started with Edulink

Edulink can be accessed via the Edulink App, found on the ios and Android App stores or through the Edulink website. The following link takes you directly to the login page. <https://edulinkone.com>

You should land on this page:

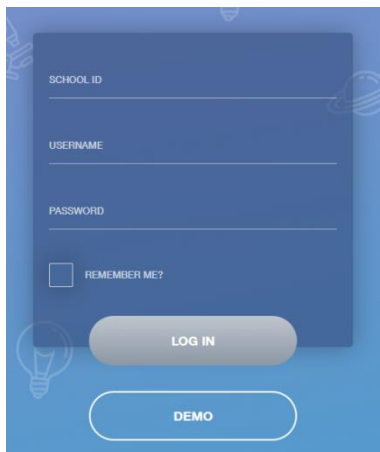

The login page features a blue background with a central white form. The form has three input fields labeled 'SCHOOL ID', 'USERNAME', and 'PASSWORD'. Below these is a checkbox labeled 'REMEMBER ME?'. At the bottom of the form are two buttons: 'LOG IN' and 'DEMO'.

The school ID is, **theforestschool**, or the postcode **RG415NE**.

To login please use your username and password. This has already been sent to you via email. Should you need any help, please contact Mrs Deer, cdeer@forest.academy.



The Edulink Home Screen looks like this. To view the information click on the relevant icon.

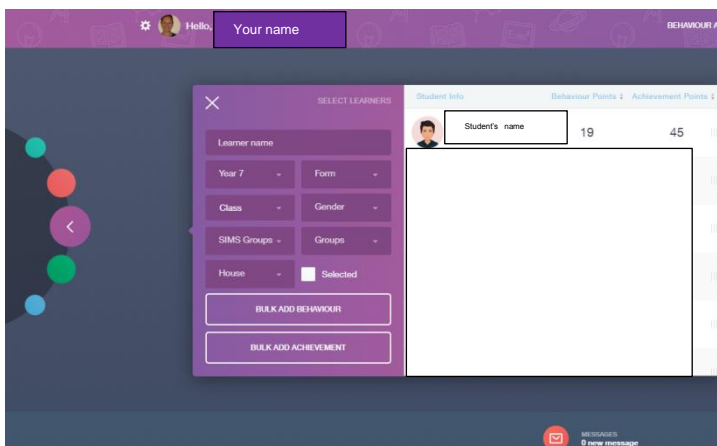

For example, clicking on the behaviour icon takes you through to this screen, which shows details of credits and discredits.

The Edulink system is refreshed each evening.